



GENUINE PARTS

INSTALLATION INSTRUCTIONS

DESCRIPTION: Rear Splash Guard Kit
APPLICATION: Quest (2011)
PART NUMBER: G8810 1JAxx (xx Designates color)

KIT CONTENTS:

Item	Qty.	Part Description	Service Part Number
A	1	Splash Guard - Rear Right	---
B	1	Splash Guard - Rear Left	---
C	2	Push pin	---
D	4	Spring nut	---
E	4	Phillips head screw	---
F	1	Installation Instruction Replacement Template	---



A



B

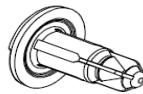

C



D



E



F

TOOLS REQUIRED:

- Clean, lint-free wiping cloth
- 90% Alcohol
- Phillips head screwdriver
- Center punch/Awl
- Drill
- 3mm (1/8"), and 6mm (1/4") Drill Bit
- Clip remover
- Cutter/Nipper
- Masking tape

PRE-INSTALLATION WARNINGS, CAUTIONS, CRITICAL STEPS, and NOTES:

- Dealer Installation Recommended, Instruction may refer to Service Manual.
- These instructions are for the left side of the vehicle; the same procedure applies to the right side.



CAUTION

- Install the Splash Guard when the ambient temperature is above 60°F (15°C).
- Do not wash or expose vehicle to a wet environment for 24 hours after installing the Splash Guard.

INSTALLATION PROCEDURE:

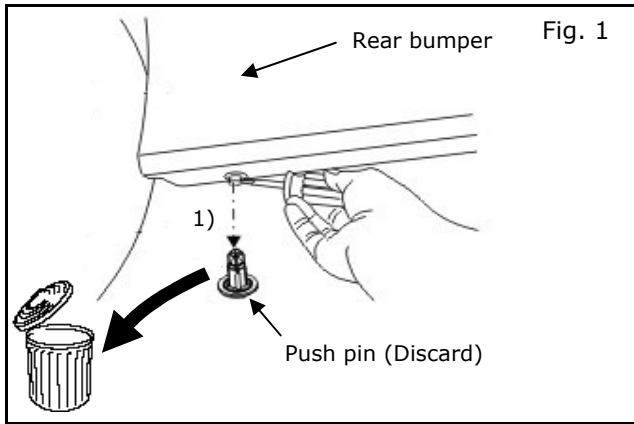

1) Remove and discard push pin from underneath vehicle.

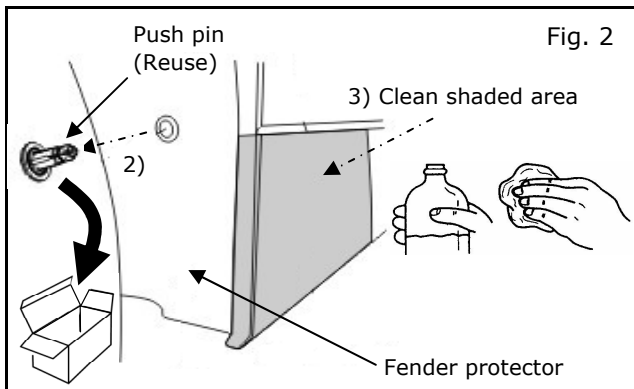

2) Remove push pin on fender protector and keep to reuse.
3) Clean installation surface (shaded area) with $\geq 90\%$ alcohol.

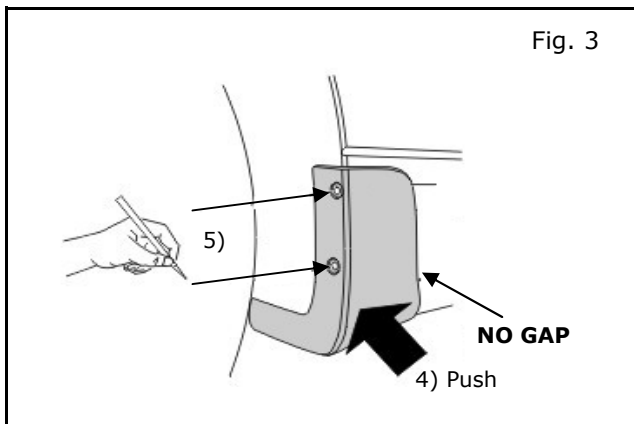

4) Align Splash Guard to vehicle, push and hold tight so there are no gaps.
5) Mark centers of Splash Guard holes using Center punch/Awl.

NOTE:

Hold Splash Guard tight to vehicle while marking center punch to ensure no gap occurs between rear bumper and Splash Guard.

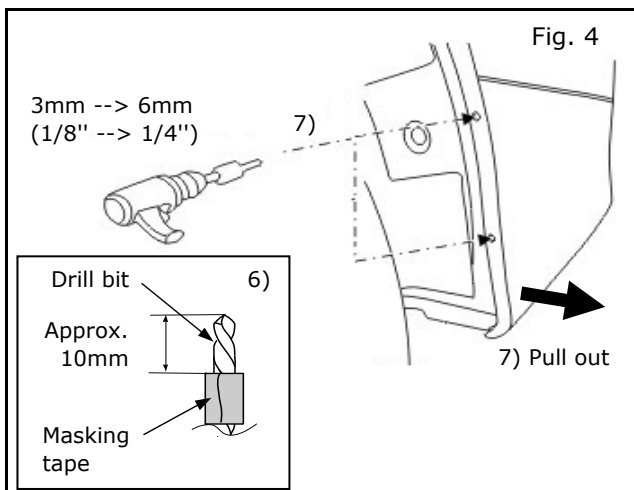

6) Wrap masking tape around 3 mm (1/8") and 6 mm (1/4") drill bit, approximately 10 mm from tip.
7) Pull out on Rear Bumper and drill 3mm (1/8") → 6mm (1/4") holes at marked locations.

INSTALLATION PROCEDURE:

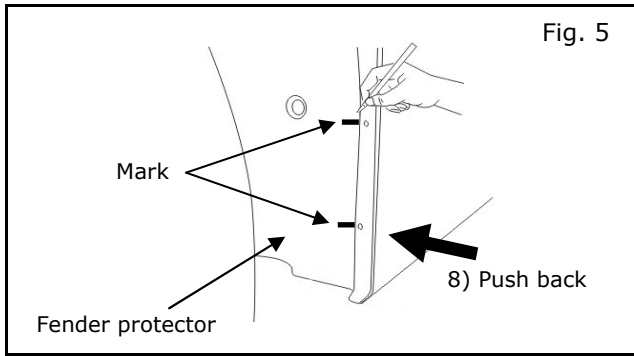

- 8) Push rear bumper in place and mark hole locations on fender protector.

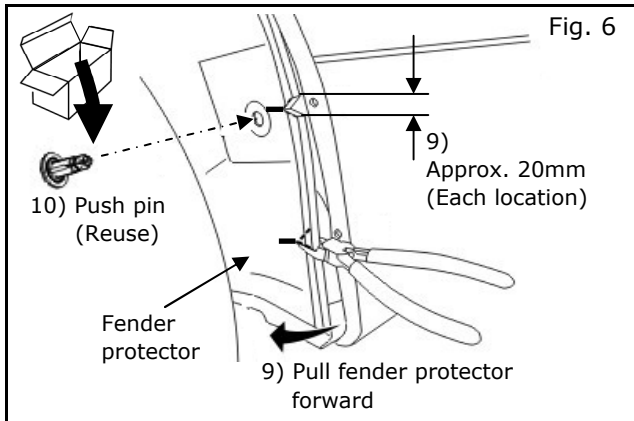

- 9) Pull fender protector forward and cut "triangle" at marked locations using cutter/nipper.
- 10) Push fender protector back in place and re-install push pin (reuse) from wheelhouse area.

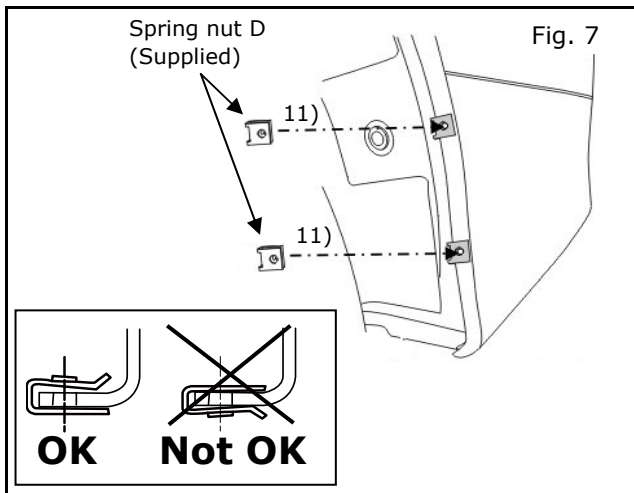

- 11) Install spring nut D (supplied) over holes in rear bumper wheelhouse area.

NOTE:

Install spring nuts (supplied) with flat edge on out side of rear bumper.

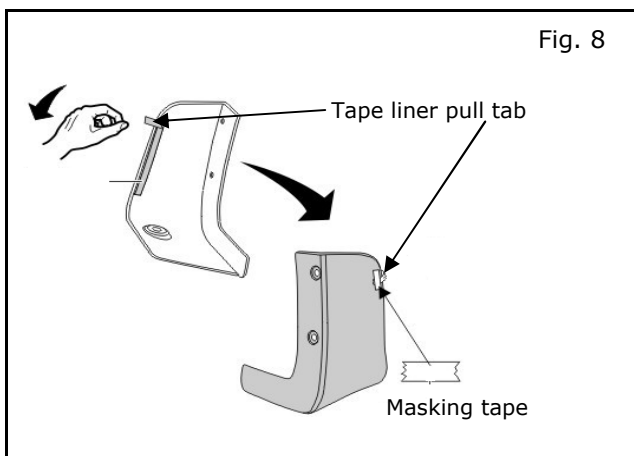

- 12) Fold Tape liner pull tab and secure to outside surface of Splash Guard with masking tape.

INSTALLATION PROCEDURE:

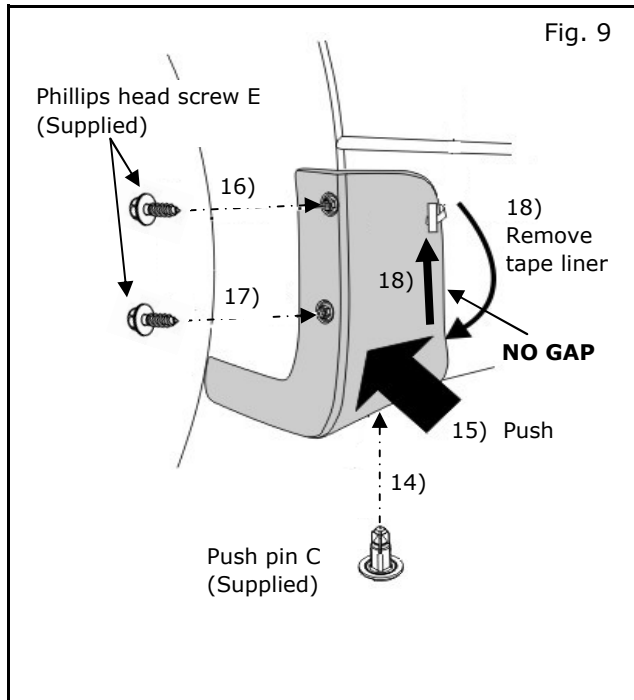

- 13) Align Splash Guard to vehicle.
- 14) Install push pin C (supplied) from underneath vehicle.
- 15) Push Splash Guard inward and upward.
- 16) Install upper Philips head screw E (supplied) in rear wheelhouse area.

NOTE:

- **Hold Splash Guard tight to vehicle while tightening screws to ensure no gap occurs between fender and Splash Guard.**
- **Do not over tighten screws. Reference Tighten Torque: 3.8~4.4 N-m {34~39 in-lb}**

- 17) Install lower Philips head screw E (supplied) in rear wheelhouse area.

NOTE:

- **Check for gaps before removing tape liner. If gap exists, remove screws and confirm hole locations are drilled correctly. If not drilled correctly, remove Splash Guard and spring nuts and modify holes accordingly.**

- 18) Remove tape liner using pull tab and apply pressure along length of tape.

NOTE:

- **Use a roller of burnish by hand to apply a minimum of 15lbs of pressure along length of tape (starting at front of part and working rearward).**

- 19) Repeat steps for passenger side.

FINAL INSPECTION

- Verify all clips are fully engaged and locked.
- Check all **torque** values. (Reference related steps and figures)
- Confirm that fender protector push pin is re-installed.